

# Golf Push Cart

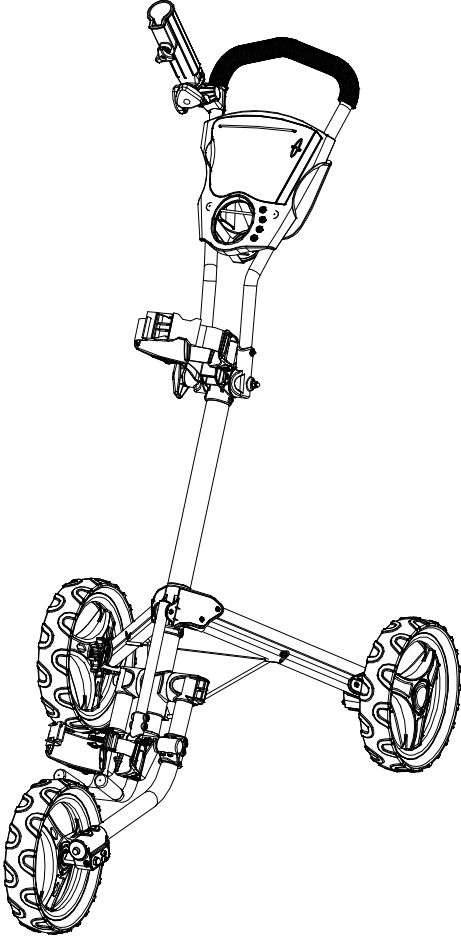

User's Manual

## Package contents:

- 1.The main frame of the cart with the front wheel
- 2.Two main wheels
- 3.Umbrella holder optional
- 4.This user's manual

## Part Identification:

- A: Foam grip
- B: Web net
- C: Scorecard holder
- D: Handle tube
- E: Upper bag holder bracket
- F: Adjustable handle mechanism
- G: Main upper frame tube
- H: Leg bracket
- I: 2 holes leg frame
- J: 3 holes leg frame
- K: Anti-splay wire
- L: Right weight stabilize
- M: Left weight stabilize
- N: Right wheel lock mechanism
- O: Left wheel lock mechanism
- P: Lower bag holder bracket
- Q: lower frame tube lock mechanism
- R: Main lower frame tube
- S: Front wheel assembly
- T: Rearr wheel
- U: Foot brake
- V: Umbrella holder
- W: Umbrella holder base

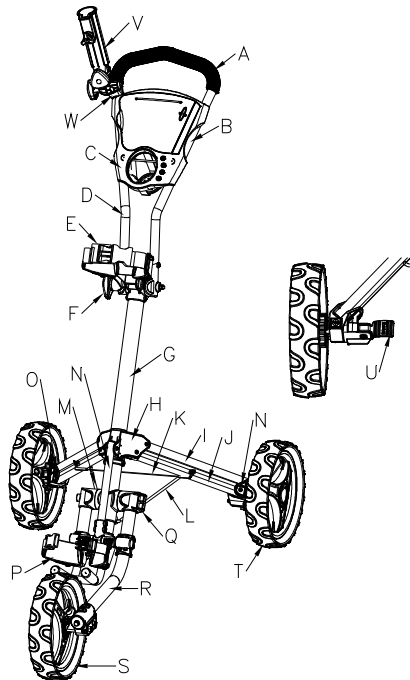

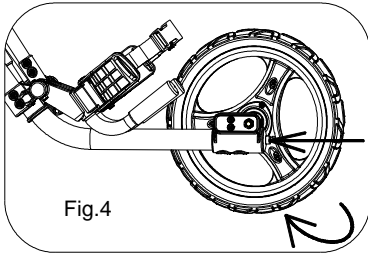

Step 4: Push the red button to rotate the front wheel clockwise 180 degrees to the inner side of the cart as in fig. 4

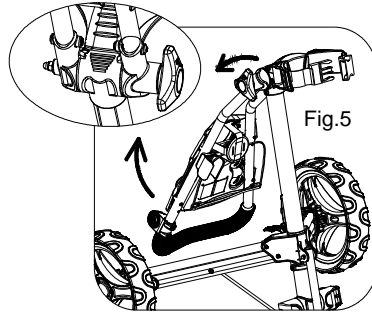

Step 5: Release the handle buckle, adjust handle to desired position, then tighten the button as in fig. 5  
The cart now is ready for use.

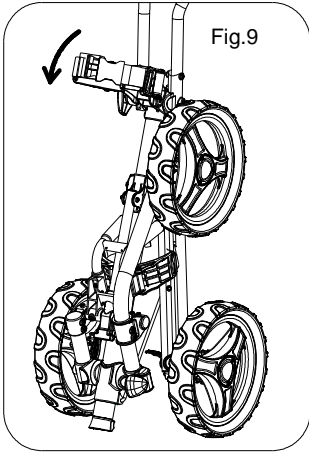

Step 3: Push the upper bag holder bracket downward to the cart folding position as in fig. 9

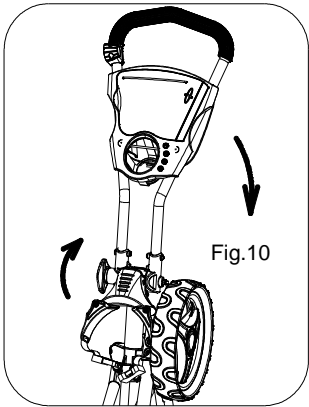

Step 4: Release the upper red button to fold the handle downward then tighten it as in pic 10

# Front Wheel Alignment Mechanism

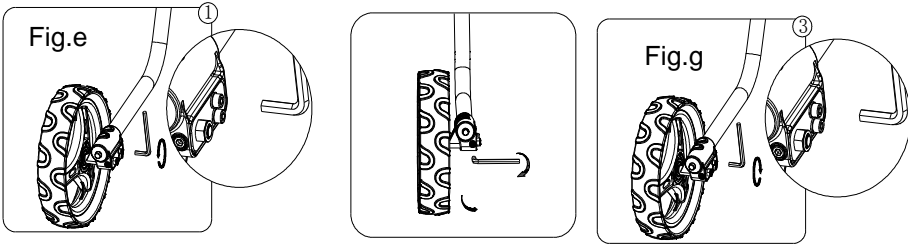

If the cart veers to the right:

Step 1: Face the front wheel of the cart and use the provided Allen wrench to loose the two side screws as Fig.e.

Step 2: Then use the Allen wrench to adjust the front bolt clockwise until the front wheel is centered. Then tighten the two side screws.

If the cart veers to the left:

Step1: The same as above.

Step 2: Adjust the front bolt counterclockwise until the front wheel is centered. Then tighten the two side screws as Fig.g.

## Adjusting & tightening the handle

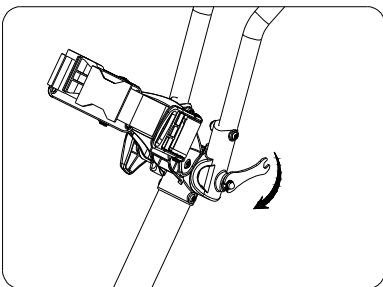

If the handle becomes loose during normal use, please use the supplied tool to tighten the handle as shown above.

## **WARNING:**

FOR YOUR OWN SAFETY, PLEASE REVIEW THESE WARNINGS AND KEEP THIS USER GUIDE FOR FUTURE REFERENCE.

- Before using this golf cart, please read and understand the important instructions and warnings in this user guide.
- AVOID INJURY by always following the folding and unfolding the cart instructions carefully.
- AVOID INJURY by keeping clear of moving parts while adjusting, folding or unfolding this cart.
- ALWAYS make sure the cart is fully extended and locked before use.
- ALWAYS make sure the cart is folded and locked properly before lifting or transporting.
- ALWAYS use the brake when parking the cart.
- DO NOT run while using this cart.
- DO NOT use accessories other than those designed specifically for this cart.
- Keep hands and fingers away from moving parts or sliding sections of the cart!

# Unfolding the cart

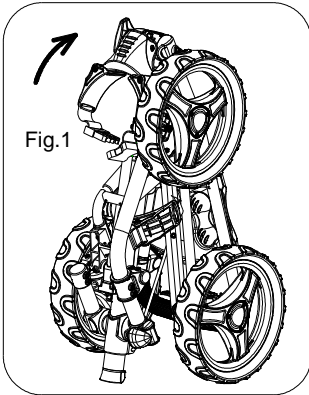

Step1: Adjust the upper bracket to proper position as in fig.1

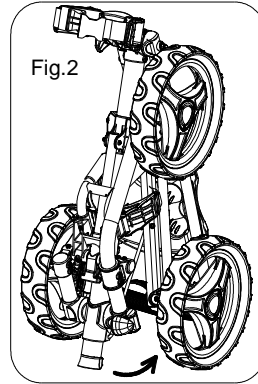

Step2: Unlock the lower red buckle to release front wheel fork as in fig. 2

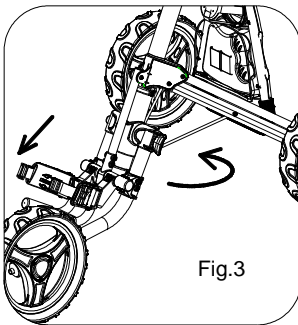

Step 3: Push the front wheel fork downward until the support bracket clicks and then lock the red buckle as in fig. 3

## Folding the cart

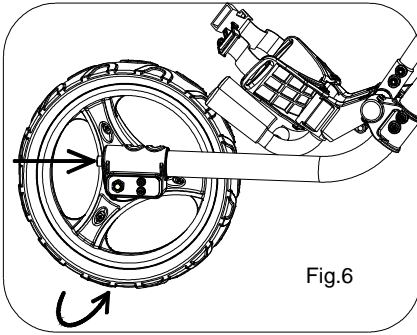

Step 1: Press the red button and rotate the front wheel counterclockwise 180 degrees to outside of the cart as in fig. 6

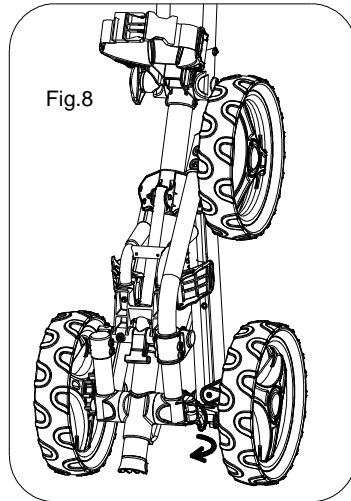
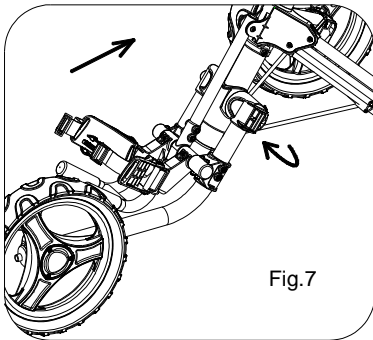

Step 2: Release the lower red buckle, fold the front wheel folk till it click to position. Lock the buckle as in fig. 7 & 8



# Umbrella Holder

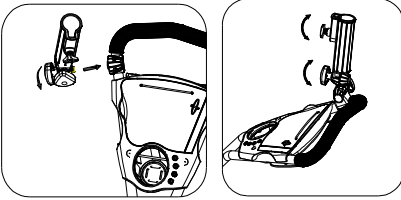

To Put In Use:  
Simply attach the umbrella holder onto the cart in fig. a&b

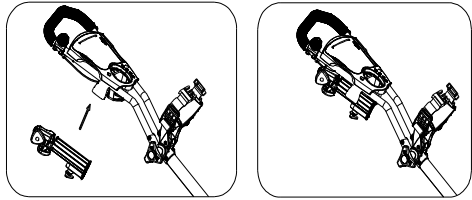

To Store:  
Attach the umbrella holder to the storage rack on the handle as in fig. c & d

Install and Remove the main wheels & use the brake

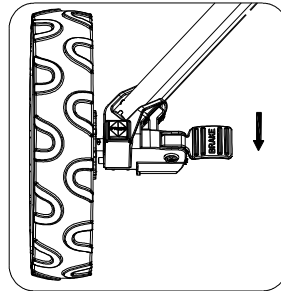
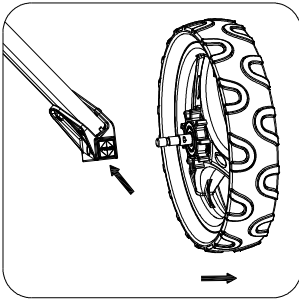

Press the red button on the wheel holder to remove or install the rear wheel.

Step on the brake pad to activate and step on again to deactivate the brake

